



## Model: 62NRF

The 62NRF range of Two Valve Manifolds provide a low cost Block and Bleed function to any instrument installation or application.

Based around the Budenberg 6N Needle Valve technology the versatility of these manifolds enable isolation, calibration and venting within a single unit thereby eliminating potential leak paths. The 62NRF range includes a full range of configurations and connections allowing them to be used on a full range of instrumentation including Transmitters, Gauges, Switches etc.

All units incorporate the Budenberg 6N high temperature, high pressure valve head assembly that is suitable for pressures up to 10,000 psig and temperatures up to 450 Degree Celsius.

These lightweight compact units can be readily manufactured, modified or configured to suit any individual application or customer requirement.

### Basic Models

62NRF - Female process x Female instrument connections.

For Direct transmitter mounting versions see additional datasheets

### Material of Construction

Standard material is 316 St St to NACE MR 01-75. Units can be manufactured in a range of wetted parts materials including Monel and Hastelloy

### Standard Connection Sizes

1/2" NPT or BSPP Female process connection and female instrument connections, Vent connection is 1/4" NPT or BSPP Female.

Other thread sizes available, contact sales for further details

### Operating Pressure

6,000 psig Cold Working Pressure designated 62Nx

10,000 psig Cold Working Pressure designated 102Nx

### Operating Temperature

-20 to 240°C maximum for units fitted with PTFE stem packing

-20 to 450°C maximum for units fitted with Graphoil packing

For Cryogenic applications then a range of extended head versions are available

### Dust Cap Identification

White Dust Cap indicates PTFE Stem Packing

Black Dust Cap indicates Graphoil Stem Packing

### Fire safe

Designed and certified to BS 6755 Pt 2, API 10497, API 607

## 2 VALVE INSTRUMENT MANIFOLD REMOTE MOUNTING VERSION



### Needle Valve Features

#### Stem Packing

Fully adjustable, dynamically responsive, multi ring 'gland sandwich' in either PTFE or Graphoil to resist all operating and processes. Budenberg offer 100% gland integrity for the lifetime of every valve

#### Stem Tip

Self centring, non rotating stem tip provides a true metal to metal valve seat whereby the material of the stem tip is one grade harder than the body thus resisting overtightening, preventing wear and guaranteeing a 100% bubble tight seat closure, first time, every time

Anti static, anti blow-out stems

True metal to metal Body / Bonnet joints. Bonnets are assembled with a locking pin to prevent accidental removal

Pressure & Temperature ratings as ANSI B 16.34 Class 2500

T' Bar operator with torque break feature

### Certification

Material Certification to EN 10204 3.1b inc Mill Certificates

Pressure Test Certificate

CE Certificate of Conformity

Other testing / documentation / certification can be supplied dependant upon the contract / project requirements.

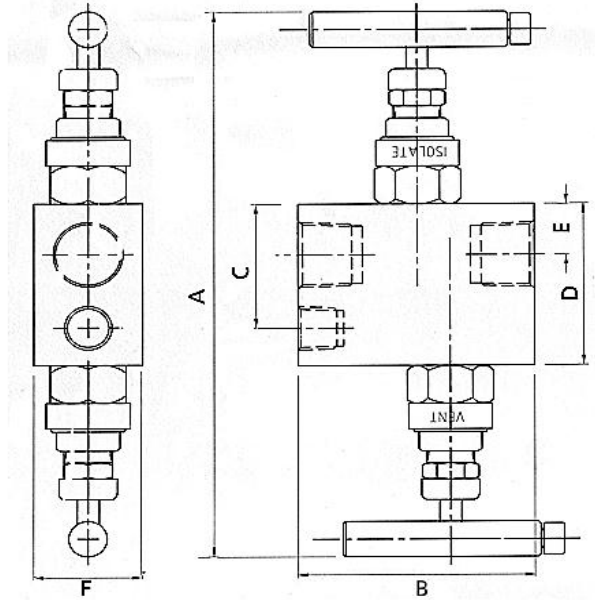

Model	A	B	C	D	E	F	Weight
62NRF	172mm	70mm	39mm	50.8mm	15.9mm	31.8mm	1 Kg

Model Number

Process

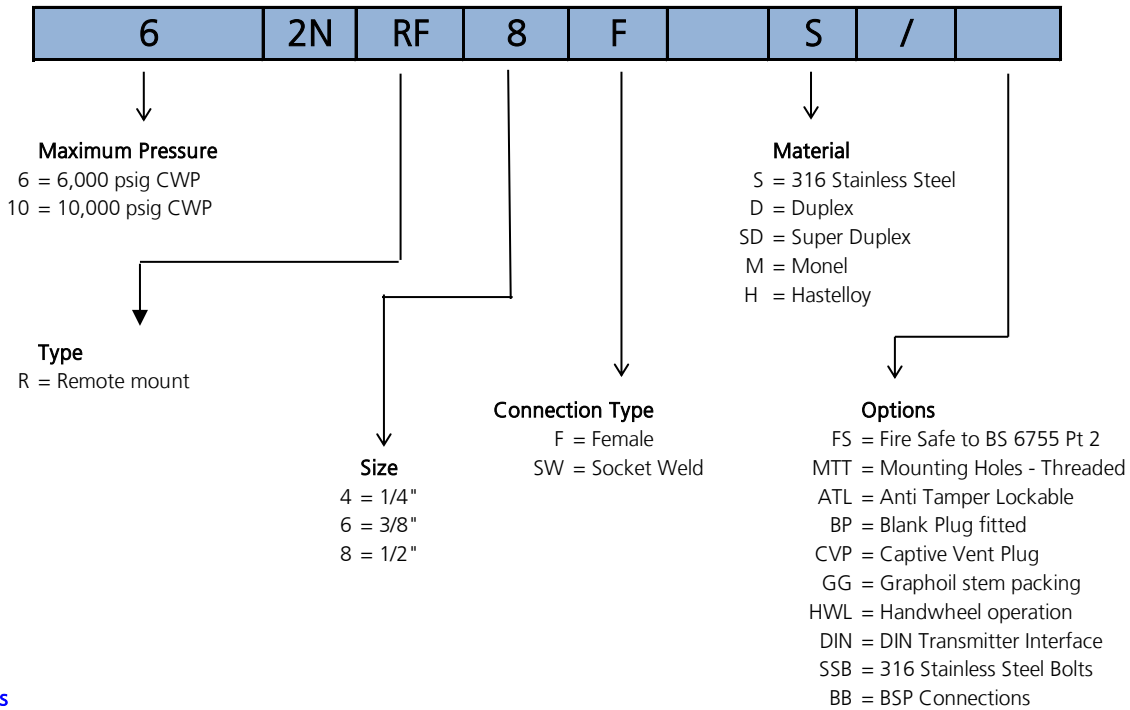

Notes

- 1 Standard Screwed connections are NPT
- 2 For units on Cryogenic Service please contact our sales office
- 3 All wetted parts material conform to NACE MR 01-75 latest version
- 4 For details of mounting brackets and other accessories please see additional datasheets
- 5 For interfacing onto other Transmitter types or configurations, please contact our sales office
- 6 Multiple options can be specified if seperated by a forward slash symbol (/)