

BOURDON TUBE PRESSURE GAUGE OXYGEN DUTY



An impressive technical specification and wide range of standard features make the PREMIUM the obvious choice for a wide range of process and engineering applications.

Embodying an all 316 Stainless Steel case and bezel construction, the 950GP incorporates a solid baffle wall and blow out back for operator protection and standard features such as IP67 environmental protection, not normally available on comparative units.

The 950GP is specifically manufactured for use on OXYGEN and as such is cleaned for Oxygen service with no oil or grease contamination.

A restrictor in the inlet is a standard feature.

Size

100 mm (4") & 150mm (6")

Mounting

Direct, Surface and Flush

Case & Bezel

Rugged one-piece full Safety Pattern case to S3 standard with a solid baffle partition wall and full blow out back manufactured in 1.6mm thick, 316L stainless steel.

Scale Ranges

0 to 600 mbar to 0 to 1400 bar Pressure
Equivalent units of pressure / vacuum available
Single and dual scales are available

Pressure Element

Monel

Overload

Units withstands overload pressure up to 130% of FSD
Overload & vacuum stops are fitted on the movement

Option: Mechanical overload clamps fitted internally to enable units to withstand up to 3x the max scale reading

Pressure Connection in 316 Stainless Steel

1/4", 3/8", 1/2" BSP

1/2" NPT

Other connections available, contact our Sales Dept for details

Accuracy Class

CL:1 1.0% of FSD as defined in EN837-1

Option: 0.5% of FSD as defined in EN837-1

Temperature

Operating: -20 to +90 °C

Storage: -40 up to +100 °C

Options: for lower or higher operating temperatures, please contact our Sales Office

Duty

Cleaned for use on Oxygen, with restrictor in inlet.



Dial

White Anodised Aluminium marked in black finish
Marked "Oxygen" and "Use no Oil" in red triangle
Single or Dual scale available

Pointer

Aluminium coloured black
Options: Micrometer adjustable pointer

Movement

Stainless Steel Construction
Option: Viscous Damped movement to overcome the effects of minor pressure pulsations

Window

3mm Laminated Safety Glass (Standard)
Option: Acrylic Plastic Window

Environmental Rating

IP67 as defined in EN 60 529

Traceability

All instruments are individually calibrated and have an unique Serial Number printed on the dial. A Certificate of Conformity Traceable to National Standards is Supplied Free of Charge

Certification available

BS EN 10204 3.1B Material Certification

Point by Point Test Certificate

Safety

All units are manufactured to comply with EN 837-1, S3 specification and other regulatory standards including PED.

Installation instructions

Refer to EN 837-2

Temperature Effect

Variation in indication caused by temperature shall not exceed $\pm 0.04 \times (t_2 - t_1)\%$ of the span where:

t1 is the reference ambient temperature in degrees Celsius

t2 is the ambient temperature in degrees Celsius

Dimensions

Model : 950GP

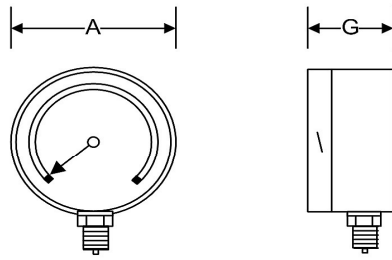

Direct Mounting 950GP

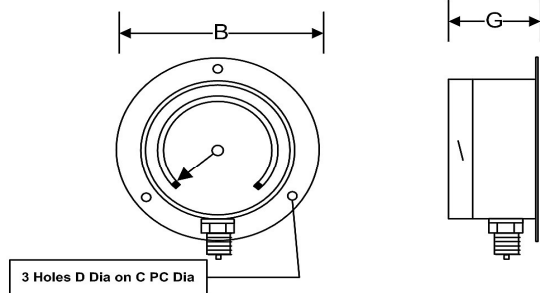

Surface Mounting 950FGP

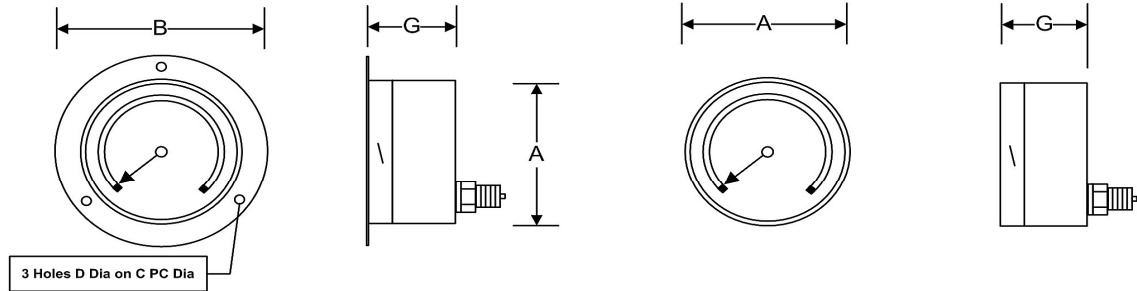

Flush Mounting 11/950GP

Direct Mounting Rear 950GP-DR

Model No	A	B	C	D	G	Weight
100mm 950GP (Dry Case)	105mm	131mm	118mm	6mm	52mm	0.7kg
150mm 950GP (Dry Case)	162mm	183mm	168mm	6mm	53mm	1.34kg

Options

- Case : DMC (Dough Moulded Compound)
- Mounting : Flush mounting clamp fixing available
- Element : 316L Stainless Steel or Phosphor Bronze
- Accuracy : 0.5% of FSD as defined in EN837-1
- Window : Acrylic Plastic Window
- Pointer : Micrometer adjustable Model 270
- Dials : Special sectors, Logos etc.

Accessories

For high temperature applications such as steam, see our range of syphons and adaptors. – See separate Datasheet.

We can supply Needle, Ball or 2 Valve manifolds for the Model 950GP – See separate Datasheet.

The manifolds in addition to allowing the instrument to operate normally allows the following: -

- a). Checking of gauge zero at line pressure.
- b). Complete isolation of the instrument.
- c). De-pressurisation of the instrument or controlled purging.
- d). Damping of pressure pulsations and surges.
- e). Inline calibration, allows in situation calibration

Specifications and dimensions in this leaflet, are subject to change without prior notice.

Budenberg Gauge Co Ltd

Unit B2, Stuart Road, Altrincham Business Park, Altrincham WA14 5GJ, United Kingdom.
+44 (0)161 777 7300 | sales@budenberg.co.uk | www.budenberg.co.uk