



## Model: BT600A

High accuracy range of Any Angle Thermometers designed for process, petrochemical and hygienic applications. Standard features include, fast, accurate and repeatable readings, fully adjustable display head, user calibration, all stainless steel construction.

Models are available in two accuracy classes to meet both HVAC and industrial process applications. The lower accuracy 1.5% fsd units are designed to meet the requirements of the HVAC market whereas the 1.0% higher accuracy units are designed for harsher industrial applications such as offshore Oil & Gas.

In addition to the standard ranges and configurations, custom units can be manufactured to meet most requirements. A full range of screwed and flanged Thermowells are available in a wide choice of materials and configurations.

### Size

100mm (4") and 150 mm (6")

### Stem Diameter

6mm, 8mm, 10mm, 12.7mm diameters in 316L Stainless Steel

### Standard Stem Lengths

100mm, 150mm, 225mm, 300mm, 400mm

Options: Other lengths available on request

Minimum insertion length of 55mm

### Mounting

Direct mounting whereby the Any Angle Head can be rotated through 360° and angled 180° from axis

### Fitting

Plain stainless steel stem supplied with compression gland

1/2" BSP or NPT as standard, others available on request

### Standard Temperature Ranges

Single Scale °C or °F
-40/+60
0/100
0/150
0/200
0/300
0/400

Other ranges including higher temperatures ranges available on request

### Accuracy Class

BT6x1 is CL:1.0 - 1.0% of FSD

BT6x5 is CL:1.5 - 1.5% of FSD

### User Calibration

External zero adjustment from rear as standard

## ANY ANGLE BI-METALLIC THERMOMETER



### Case

304 Stainless Steel

### Bezel

304 Stainless Steel

### Window

3mm Glass Window

Option: Acrylic Plastic safety window

### Dial

White Anodised Aluminium with black markings

### Pointer

Black Anodised Aluminium

### Environmental Rating

IP66 as defined in EN 60 529

### Traceability

All instruments are individually calibrated and have an unique Serial Number printed on the dial. A Certificate of Conformity Traceable to National Standards is Supplied Free of Charge

### Certification available

BS EN 10204 3.1B Material Certification

Point by Point Test Certificate

### Safety

All units are manufactured to comply with International and other regulatory standards including PED

### Installation Instructions

The use of thermowells is recommended in pipe work, vessels or pressurised systems above 3.5 bar, to provide protection against high pressures and to facilitate removal of the thermometer without depressurising or draining the system

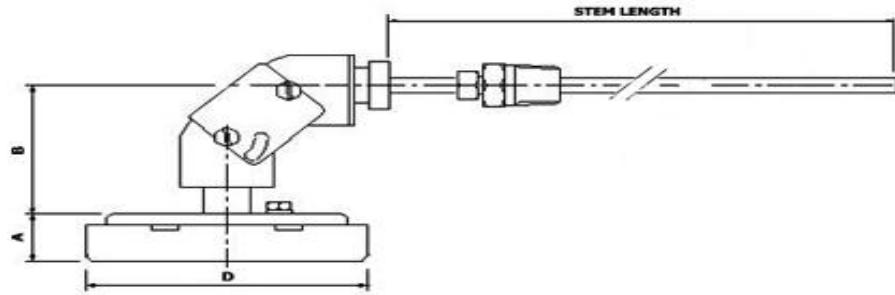

Model No	Dial Size	Accuracy	A	B	D	Weight
BT641	100mm	1.0% fsd	25mm	42mm	118mm	0.46 Kg
BT645	100mm	1.5% fsd	25mm	42mm	118mm	0.46 Kg
BT661	150mm	1.0% fsd	25mm	42mm	160mm	0.62 Kg
BT645	150mm	1.5% fsd	25mm	42mm	160mm	0.62 Kg

**Ordering Specification**

**Size mm**

- 100mm
- 150mm

4
6

**Accuracy**

- 1.0% fsd
- 1.5% fsd

1
5

**Case / Bezel**

- 304 St St
- 316 St St

0
1

**Stem Diam**

- 6mm
- 8mm
- 10mm
- 12.7mm

6
8
10
12

**Stem Length**

- 100, 150, 200, 300, 400 mm
- Others - state requirement

--

**Temperature Range**

- From table or state requirement

--

**Units**

- °C, °F or °C & °F

--

**Connection Glands**

- 1/2" NPT -1, 1/2" BSP -2,
- 3/4" BSP -3, 3/4" NPT -4
- Others - state requirement

--

<b>Code</b>	BT6			A						
-------------	-----	--	--	---	--	--	--	--	--	--

<b>Example Order</b>	BT6	4	1	A	0	6	200	100	°C	1
----------------------	-----	---	---	---	---	---	-----	-----	----	---

Any Angle Bi-metallic Thermometer, 100mm Dial, 1% Accuracy, 304 St St Case, 6mm stem, stem length = 200mm, range 0-100 Deg C, 1/2" NPT connection